



Seat No. \_\_\_\_\_

**HAA-161001010704**

**B. Architecture (Sem. VIII) (End Sem.) Examination**

**May - 2023**

**History of Architecture - V**

Time : 2 Hours / Total Marks : 50

- 1 Write a note on the characteristics of Postmodern architecture. 5
- 2 Write a note on Socio-Political situations that impacted the life of people post WW II. 10

**OR**

- 2 Write a note on The Timeless Way of Building by Christopher Alexander. 10

- 3 Multiple Choice Questions : 5

- (a) Postmodern architecture can be identified by its use of which of the following?
- (A) Symmetry (B) Utility
- (C) Asymmetry (D) Cosmopolitan
- (b) Modernism in architecture is best defined by \_\_\_\_\_.  
(A) Form follows function  
(B) Function follows form  
(C) Originality and symbolism matter  
(D) Asymmetry is beautiful
- (c) After World War II, hundreds of playgrounds were designed in Netherlands, Amsterdam by \_\_\_\_\_.  
(A) Alison and Peter Smithson  
(B) Also Van Eyck  
(C) Herman Hertzberger  
(D) Le Corbusier
- (d) Learning from Las Vegas is a book by  
(A) Denise Scott Brown Et. El  
(B) Christian Norberg Schulz  
(C) Aldo Van Eyck  
(D) Christopher Alexander

- (e) Guggenheim Museum in New York is designed by  
 (A) Frank Gehry (B) Le Corbusier  
 (C) Frank Lloyd Wright (D) Eero Saarinen

4 Match the following and explain any one Building in detail : 10  
**Styles Buildings**

(A) Charles Correa

(1)

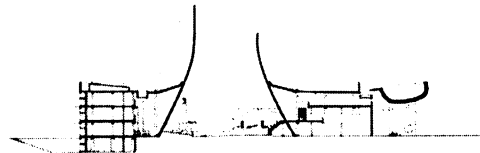

(B) Le Corbusier

(2)

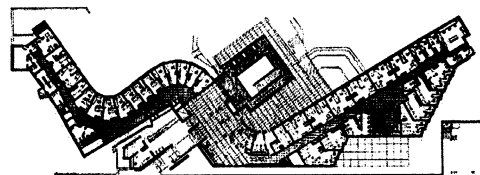

(C) Frank Lloyd Wright (3)

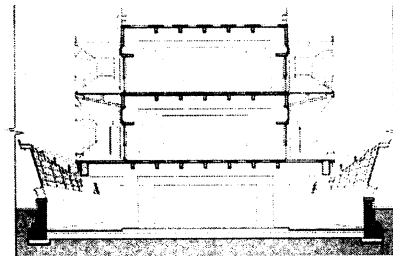

(D) B. V. Doshi

(4)

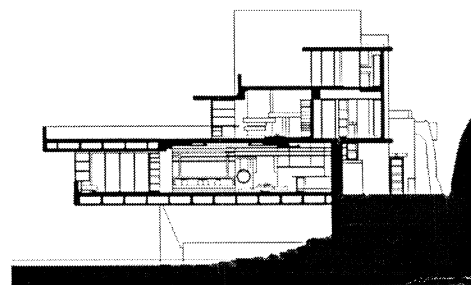

(E) Alvar Aalto

(5)

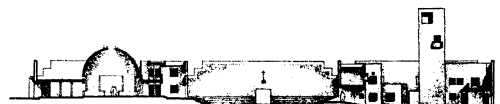

5 Architecture of post-modern period is PLURAL Explain this statement by looking at three different positions/architects' work. 20